

# Installation

## S19-690

10-Gallon Tank with Eyewash and Hose Spray

Réservoir de 10 gallons avec douche oculaire et douchette

Depósito de 10 galones con lavaojos y manguera de aspersión

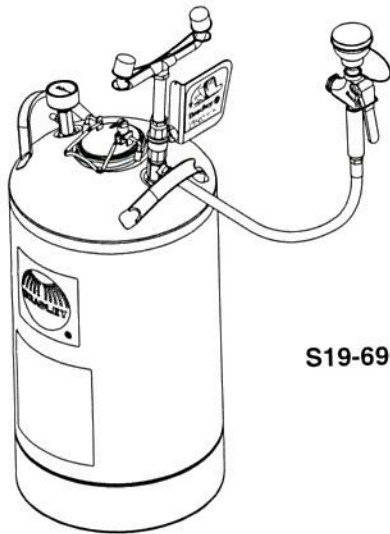

S19-690

## S19-690LHS

10-Gallon Tank with Eyewash

Réservoir de 10 gallons avec douche oculaire

Depósito de 10 galones con lavaojos

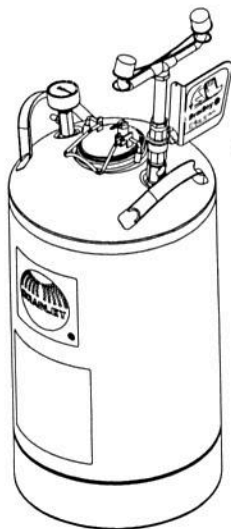

S19-690LHS

### Table of Contents

Pre-Installation Information .....	2
Dimensions .....	3
Eyewash Installation .....	3
Filling the Tank. ....	4
Maintenance & Troubleshooting .....	5
S19-690 Components & Parts List .....	6
S19-690LHS Components & Parts List. ....	7

### Table des matières

Avant l'installation .....	8
Dimensions .....	9
Installation de la douche oculaire .....	9
Remplissage du réservoir .....	10
Entretien et dépannage .....	11
S19-690 Composantes et liste des pièces .....	12
S19-690LHS Composantes et liste des pièces. ....	13

### Contenido

Información previa a la instalación .....	14
Dimensiones .....	15
Instalación del lavaojos .....	15
Llenar el tanque. ....	16
Mantenimiento y resolución de problemas .....	17
S19-690 Componentes y lista de piezas. ....	18
S19-690LHS Componentes y lista de piezas .....	19



## IMPORTANT



Read this installation manual completely to ensure proper installation, then file it with the owner or maintenance department. Compliance and conformity to drain requirements and other local codes and ordinances is the responsibility of the installer.



Separate parts from packaging and make sure all parts are accounted for before discarding any packaging material. If any parts are missing, do not begin installation until you obtain the missing parts.



The inspection and testing results of this equipment should be recorded weekly to verify proper operation. This equipment should be inspected annually to ensure compliance with ANSI Z358.1.



Workers who may come in contact with potentially hazardous materials should be trained regarding the placement and proper operation of emergency equipment per ANSI Z358.1.



For questions regarding the operation or installation of this product, visit [www.bradleycorp.com](http://www.bradleycorp.com) or call 1-800-BRADLEY.

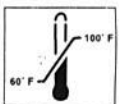

This unit is to be used with tepid, potable water as defined by ANSI Z358.1. (Note: avoid prolonged exposure to ambient heat sources above 100° F, or below 60° F).



Failure to lift unit by the provided handles may damage unit.

**NOTICE!** Avoid cleaners containing organic solvents, alcohols, and hydrocarbons. Rinse with water after cleaning.

### Supplies Required:

- Pipe sealant
- Air pressure equipment or supply (clean and free of oil contaminants) capable of up to 100 psi
- Sign-mounting hardware
- Adjustable wrench

## Dimensions

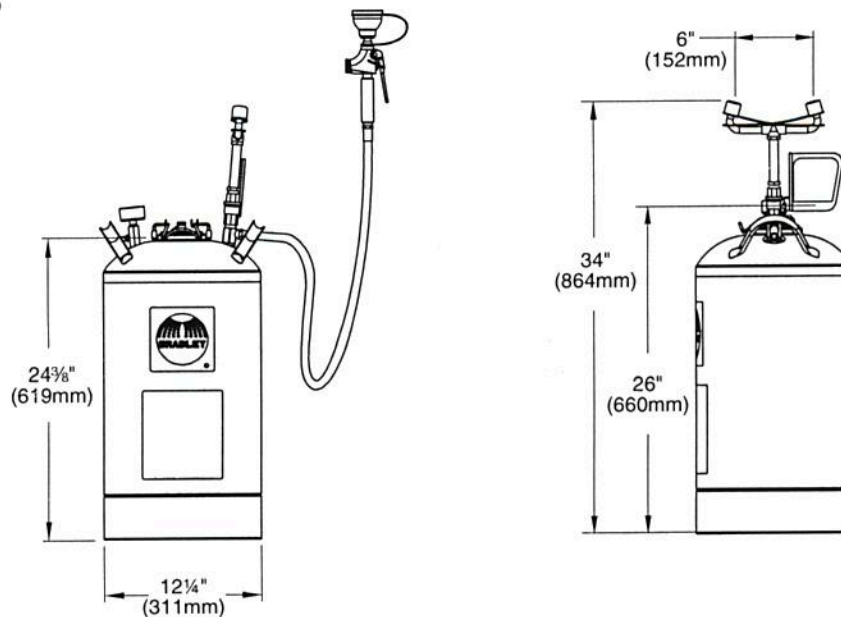

### 1 Eyewash installation

- ☒ Remove the plastic dust plug from the bottom of the yoke assembly and discard.
- ☒ Hose spray for S19-690 model only. Do not attach body wash spray head at this time.

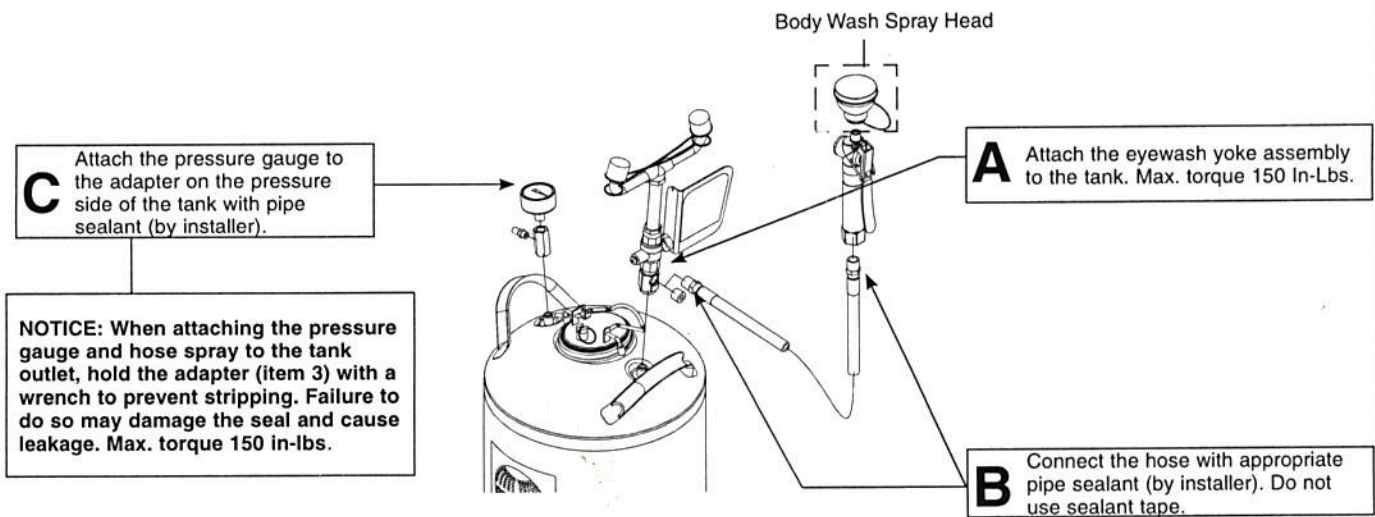



## 2 Filling the Tank

### Fill tank and pressurize

**CAUTION!** DO NOT open the cover until the pressure gauge reads "0."

1. Open the tank by pulling up on the wire handle located on top of the Quick-lock cover. Push down, rotate and remove. Make sure that the interior of the container is clean. Fill the container with 8 gallons of tepid potable water.
2. Replace the cover and secure by pulling up on the cover and down on the wire handle.
3. After filling the tank with tepid water and before pressurizing the unit, open the activation valve to the full open position and remove the dust covers from the eyewash heads.
4. Located beneath the pressure gauge is an air valve. Remove protective cover and begin to pressurize the unit by applying pressured air through the valve. As soon as water begins discharging from the eyewash heads, close the activation lever completely. Finish pressurizing the tank to 90 psi and replace the air valves protective cover.

☒ If this is the initial startup of this unit or if the unit has been unfilled and/or un-pressurized for a prolonged period of time the unit should be flushed out per the procedure below.

☒ Prior to placing unit in service let unit stand for one hour. If there is a noticeable pressure drop, re-pressurize and let stand for an additional hour. If unit continues to exhibit pressure loss DO NOT place unit in service and consult the Troubleshooting guide found on page 5 of this manual.

**CAUTION!** Relief valve is designed to vent automatically at 100-130 psi to prevent the tank from over pressurizing. If the gauge ever reads more than 130 psi immediately open the pressure relief valve manually by pulling up on the relief valve tab until the pressure reads zero. Remove the unit from service and consult the troubleshooting guide found on page 5 in this manual for steps to correct the problem. Return the unit to service only when over-pressurization issue is corrected.

### Flush tank

1. Be sure the unit is assembled, filled and pressurized according to Steps 1 & 2 above, (If this is the initial start up of the unit the body wash spray head will not be attached to the drench hose activation valve at this time.)
2. Discharge the water through the eyewash and hose spray (if provided with unit) for at least five minutes to flush the system.
3. Flush all remaining fluid in the tank.
4. Attach the body wash sprayhead (S19-690).
5. Refill the tank and pressurize as described in Step 2 above.

## Maintenance

**WARNING!** Follow instructions of the preservative manufacturer for the proper use of water preservative.

### Inspect eyewash unit

1. Visually inspect the pressure gauge weekly to ensure the unit is maintaining the proper pressure. If the unit is not working properly, remove it from the hazard area immediately and refer to the troubleshooting instructions. For further assistance, contact the Bradley Corporation.

### Clean eyewash unit

When using potable water only:

1. Empty the tank any time from once per week to once per month, depending on the quality of your water supply. The manufacturer is not responsible for variations in the water supply.
2. Clean the inside of the tank using warm water and mild soap. Rinse the tank thoroughly with warm water.
3. Refill the eyewash tank with tepid potable water.

When using potable water and water preservative (recommended):

1. Clean the inside of the tank using warm water and mild soap. Rinse the tank thoroughly with warm water.
2. Refill the eyewash tank with tepid potable water. Follow instructions of the preservative manufacturer for the proper use of water preservative.

## Troubleshooting

1. If pressure relief valve relieves prior to the required pressure, do the following (when in the unpressurized condition):
  - Tighten the valve completely into the cap by turning the gray hex head portion of the pressure relief valve clockwise. Do not use a wrench.
  - Pull up on the relief valve ring and ensure that the ring is not preventing the valve from closing completely. Push on the center pin of the relief valve to ensure that it is completely closed. Repressurize tank to required pressure. This may have to be done several times to get the valve to seat completely.
2. If the pressurized tank loses pressure over time, check the connections with diluted liquid dish soap or children's bubbles to identify the leak location. Tighten the connection slightly and test again.

## Assembly of Components and Parts List - S19-690

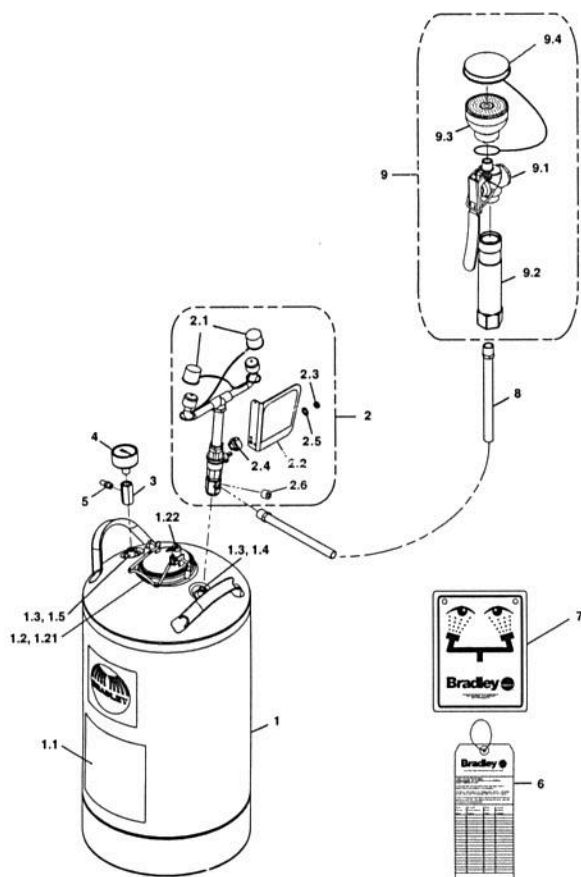

Item	Part No.	Qty.	Description	Item	Part No.	Qty.	Description
1	S39-785	1	Tank, 10-Gallon	2.5	142-002DA	1	Lockwasher
1.1	204-641	1	Operating Instr. Label, English	2.6	169-043	1	Plug (do not save)
	204-641FC	1	Operating Instr. Label, French	3	153-451	1	Adapter
	204-641M	1	Operating Instr. Label, Spanish	4	169-786	1	Pressure Gauge
1.2	S44-024	1	Lid Assembly	5	S27-320	1	Tank Valve Assembly
1.21	269-1410	1	Gasket	6	204-421	1	Emergency Inspection Tag
1.22	269-1642	1	Relief Valve	7	114-051	1	Safety Sign
1.3	269-1411	2	O-Ring	8	S89-002	1	3/8" Yellow Tube
1.4	269-1516	1	Draw Tube	9	S39-817	1	Hose Spray
1.5	269-1515	1	Level Indicator Tube	9.1	S27-332	1	Valve, Hose Spray
2	S05-182	1	Eyewash Valve Assembly	9.2	128-182	1	Handle
2.1	107-371	2	Tethered Dust Cover	9.3	S45-2453	1	Service Kit EFW - Black Sprayheads
2.2	S08-336	1	Handle/Label Assembly	9.4	S53-063	1	Tethered Dust Cover
2.3	110-215	1	Nut				
2.4	153-372R	1	Adapter				

S45-2410 includes Items 1.21, 1.3



## Assembly of Components and Parts List - S19-690LHS

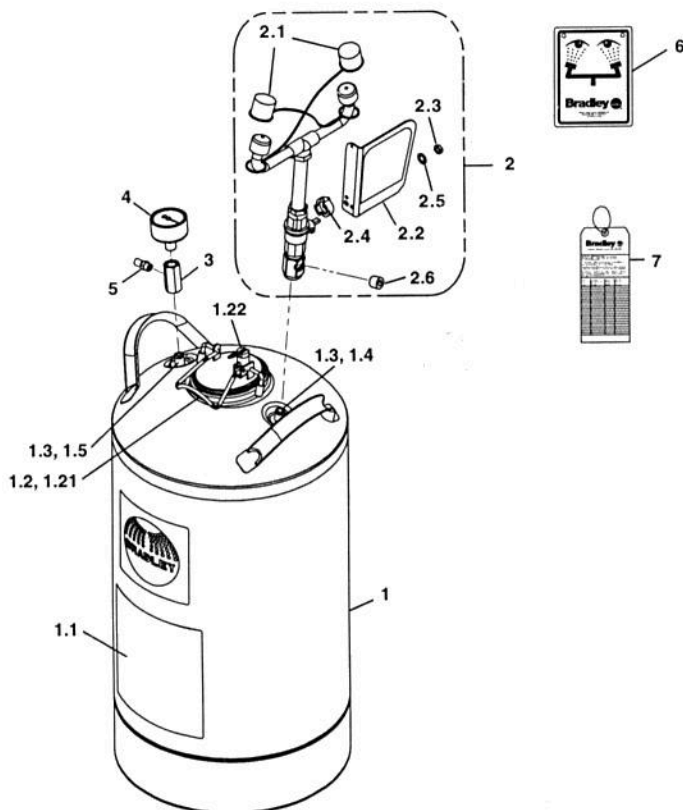

Item	Part No.	Qty.	Description	Item	Part No.	Qty.	Description
1	S39-785	1	Tank, 10-Gallon	2.1	107-371	2	Tethered Dust Cover
1.1	204-641	1	Operating Instr. Label, English	2.2	S08-336	1	Handle/Label Assembly
	204-641FC	1	Operating Instr. Label, French	2.3	110-215	1	Nut
	204-641M	1	Operating Instr. Label, Spanish	2.4	153-372R	1	Adapter
1.2	S44-024	1	Lid Assembly	2.5	142-002DA	1	Lockwasher
1.21	269-1410	1	Gasket	2.6	169-043	1	Pipe Plug, 3/8"
1.22	269-1642	1	Relief Valve	3	153-451	1	Adapter
1.3	269-1411	2	O-Ring	4	169-786	1	Pressure Gauge
1.4	269-1516	1	Draw Tube	5	S27-320	1	Tank Valve Assembly
1.5	269-1515	1	Level Indicator Tube	6	114-051	1	Safety Sign
2	S05-182	1	Eyewash Valve Assembly	7	204-421	1	Emergency Inspection Tag

S45-2410 includes Items 1.21, 1.3